

A90 Burnshot Bridge

Progress Update No 8

29 January 2018

Introduction

This note provides an update to Progress Update No 7.

Footpath / cycleway

Construction of the new footpath/cycleway along the Northbound slip road is progressing well following the discovery (and repair) of some damaged road gullies along its length. Over 50% of the surfacing is now complete. The large green direction sign for the Burnshot exit will be removed to make way for the new path, and so this sign will be replaced with a white alternative in accordance with current standards for the road.

It is expected that the path will be fully open to users in early March.

Temporary service bridge

The opening of the temporary service bridge for pedestrians is still under investigation. A Scottish Power cable crosses along the walkway of the bridge but following a meeting with Scottish Power, with suitable protection of the cable, it should be possible to permit public access. A structural assessment of the bridge, minor earthworks and new footpath construction will also be required. This scheme is now being developed and priced. Any works will be undertaken as an extension to the demolition contract with Balfour Beatty.

As noted in last month's update, this service bridge was not initially intended for pedestrians, so there are still no guarantees for public access.

New Bridge

A programme has now been developed for the feasibility design of the bridge, which will inform the tender documentation. The Council, AECOM and Balfour Beatty are all working together to develop this design, and undertake the relevant surveys and investigations. The following surveys have now been completed:

- Topographical Survey – to accurately determine the layout of approach roads and surrounding infrastructure, and verify the laser scan (see below).
- Point cloud laser scan – this is a 3D survey which generates millions of points to accurately map the leftover concrete and existing road/ground levels. This survey will facilitate the production of a 3D model to aid with the design work.
- Ecological survey – to identify the potential ecological impacts of the construction of a new bridge. Only 'Low' risks were identified:
 - Although no badgers are currently present, a further badger survey is required prior to construction.
 - Breeding birds are to be managed during construction (all vegetation clearance to be outside the breeding season, otherwise check for nests and exclude works as necessary until breeding finished)
 - Rhododendron (invasive species) is present nearby but isn't expected to affect works.
- Geotechnical desk study – to ascertain some idea of the ground conditions to inform the foundation design of the new bridge, in advance of boreholes and trial pits which will take place later.

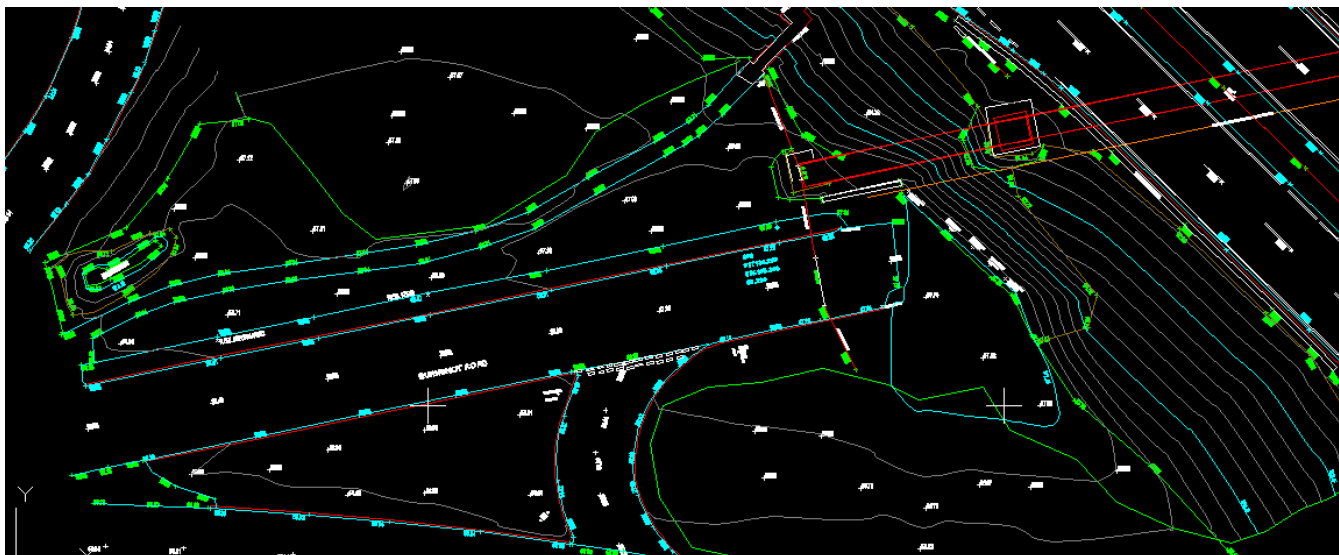

Extract from topographical survey

A stakeholder consultation process has now commenced. Numerous organisations with an interest in the bridge have been contacted to inform them of the outline proposals for replacement of the structure, and to invite comments by 23rd February 2018. If you have any comments, please let me know by this date. After this date there will be no further consultation, but regular updates will be continued via this medium.

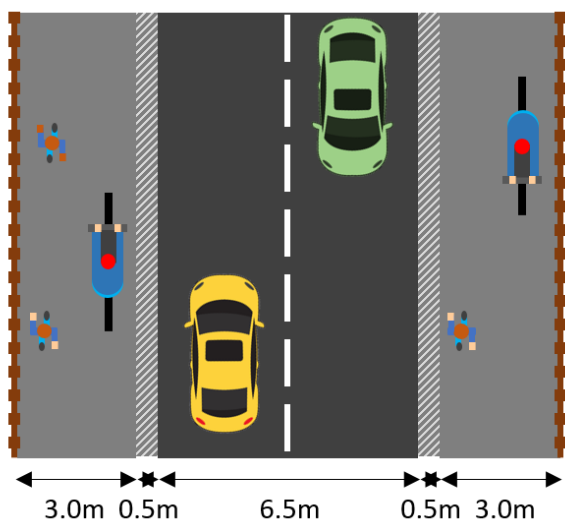

Proposed geometry layout of new bridge

A decision on funding for the construction of the new bridge is still awaited, and expected in February when capital budgets are set for the 2018/19 financial year.